



# VELOX CNC

VELOX CNC  
1746 West Katella Ave. STE6  
Orange, CA 92897  
Office: (714) 639-3639  
Fax: (714) 639-3669

## Parallel Port Settings (Ports&Pins)

If the parallel port is not communicating with your control box you may manually check your ports&pins settings by following the steps below. Please call a VELOX CNC rep. if your issue persists.

Windows 7 & 10: Click **Start** → Type in the Search Bar: **device manager** → Click on the icon

1.) Click on the **expandable arrow icon** to show the list of Ports. Look for LPT1-LPT3. You may have more than one LPT port which will require you to use this process until you identify the correct one to use.

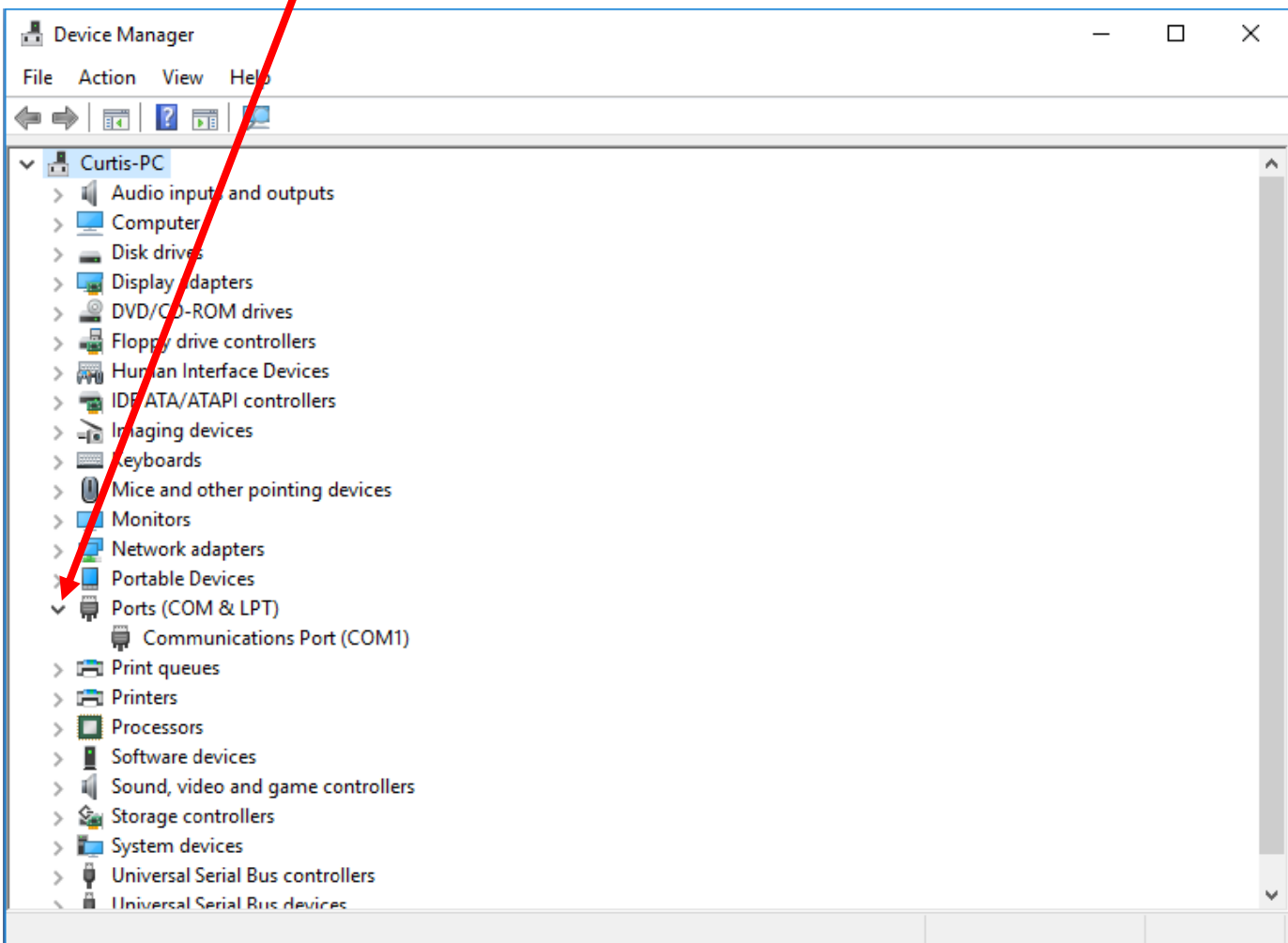

2.) Click on the tab for: **Resources**. Write down the first four digits of the **I/O Range**

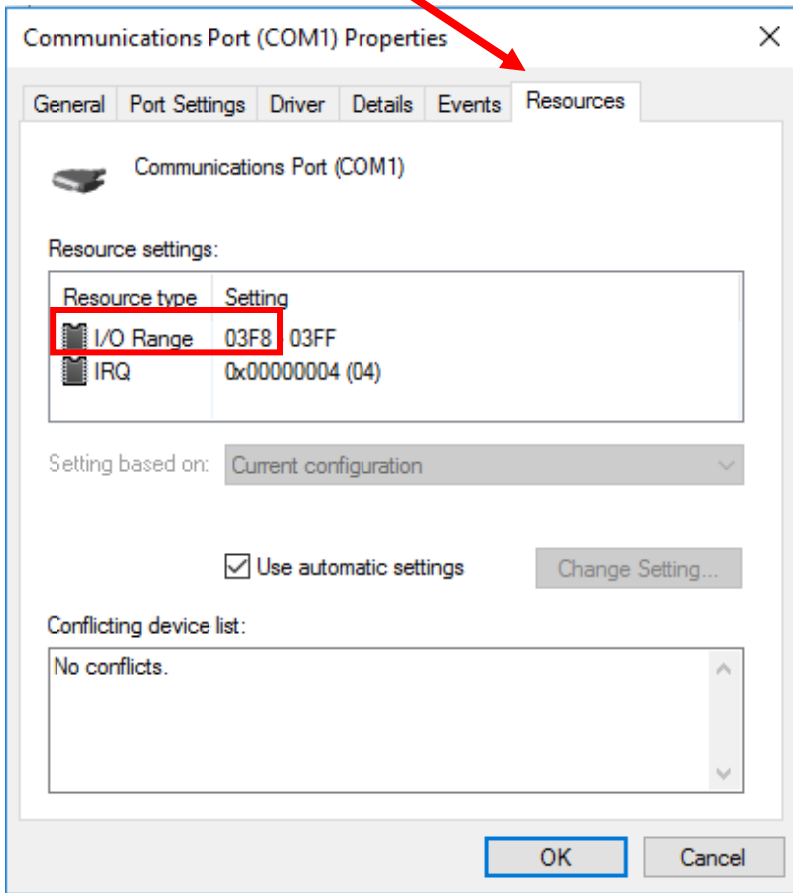

3.) Enter in those four digits into the **Port #1** and ensure that it is enabled. Then click ok.

